

5001 Series Modular Plug

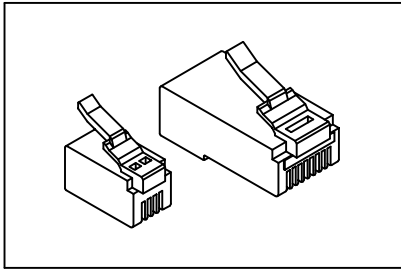

Features:

- * UL recognized, CSA listed.
- * 50µ" gold meets FCC 68 requirements.
- * Available in 4, 6, 8, 10 position housing.
- * Industry compatible profiles and foot prints.
- * Available in selective loading.
- * Contact pre-loaded and self aligned.

Material:

- Housing: Polycarbonate UL94V-2.
- Contacts: Phosphor Bronze.
- Plating: Gold plated on contact area over Nickel.

Electrical Characteristics:

- Current Rating: 2 AMP.
- Insulator Resistance: 5000MΩmin. at DC 500V.
- Contact Resistance: 30mΩmax. at DC 100mA.
- Operating Temperature: -55°C ~ +105°C.
- Capacitance: 1.5pF max between adjacent contacts.

Mechanical Characteristics:

- Durability: 250 cycles.
- Retention Force: 7.7kg between jack & plug.
- Max Total Mating Force:
 - 2 contacts loaded-350g.
 - 4 contacts loaded-500g.
 - 6 contacts loaded-750g.
 - 8 contacts loaded-900g.
 - 10 contacts loaded-1100g.

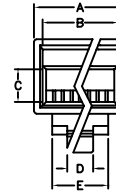
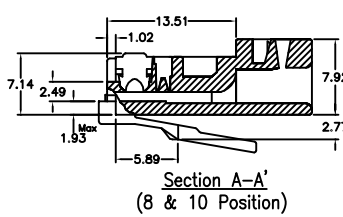
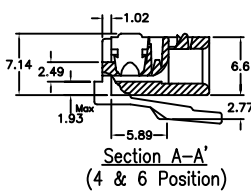
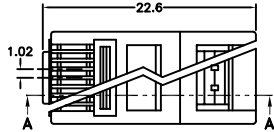
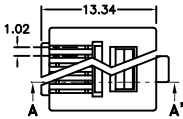

No. of Position	No. of Contacts	Dimensions				
		A	B	C	D	E
4	4	7.62	5.18	3.06	2.54	4.98
6	2	9.65	7.21	1.02	3.25	6.05
6	4	9.65	7.21	3.06	3.25	6.10
6	6	9.65	7.21	5.10	3.25	6.10
8	8	11.68	8.18	7.14	3.25	6.10
10	10	11.68	8.18	9.18	3.25	6.10

Ordering information

<u>5001</u> Series	<u>10</u> 10: 10 Position Housing 8: 8 Position Housing 6: 6 Position Housing 4: 4 Position Housing	<u>10</u> 10: 10 Contacts Loaded 8: 8 Contacts Loaded 6: 6 Contacts Loaded 4: 4 Contacts Loaded 2: 2 Contacts Loaded	<u>/50</u> 50: 50µ" Gold Plated 30: 30µ" Gold Plated 15: 15µ" Gold Plated 6: 6µ" Gold Plated
-----------------------	---	---	--